

COMPLETE MOLDED BASE ASSEMBLY
ITEM 72 PART NO. 59576-601

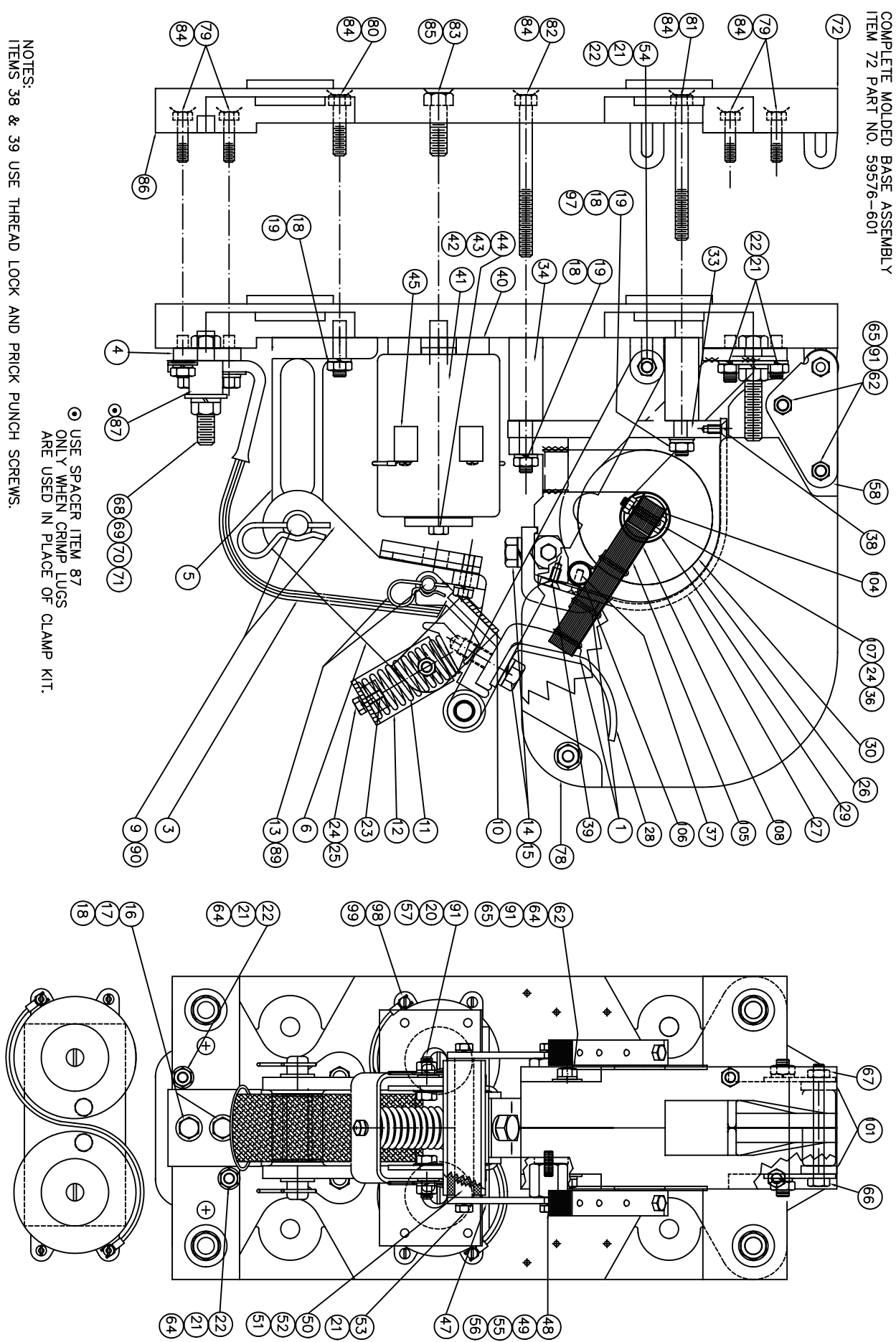

NOTES:
ITEMS 38 & 39 USE THREAD LOCK AND PRICK PUNCH SCREWS.
○ USE SPACER ITEM 87 ONLY WHEN CRIMP LUGS ARE USED IN PLACE OF CLAMP KIT.

Rev	DATE	BY	DESCRIPTION	LINE#	QTY	UNIT	MOE	LANGES	DRG. NO.	1 OF 2
E	9-22-00	TJJ	ADDED ITEM 97	1	1	1			REPAIR PARTS BULLETIN 5110	
D	2-22-00	TJJ	UPDATED DRAWING	1	1	1			MOLDED BASE FRONT REMOVABLE	
C	11-21-97	TJJ	ADDED ITEMS 109 & 110	1	1	1			900 AMP, 1 POLE, N.O.	
B	6-27-96	WSM	ARC TRANSFER WINGS CHANGED	1	1	1			AC CONTACTOR, SIZE 7	
A	6-27-96	WSM		1	1	1				