

COMPLETE MOLDED BASE ASSEMBLY
ITEM 72 PART NO. 59576-601

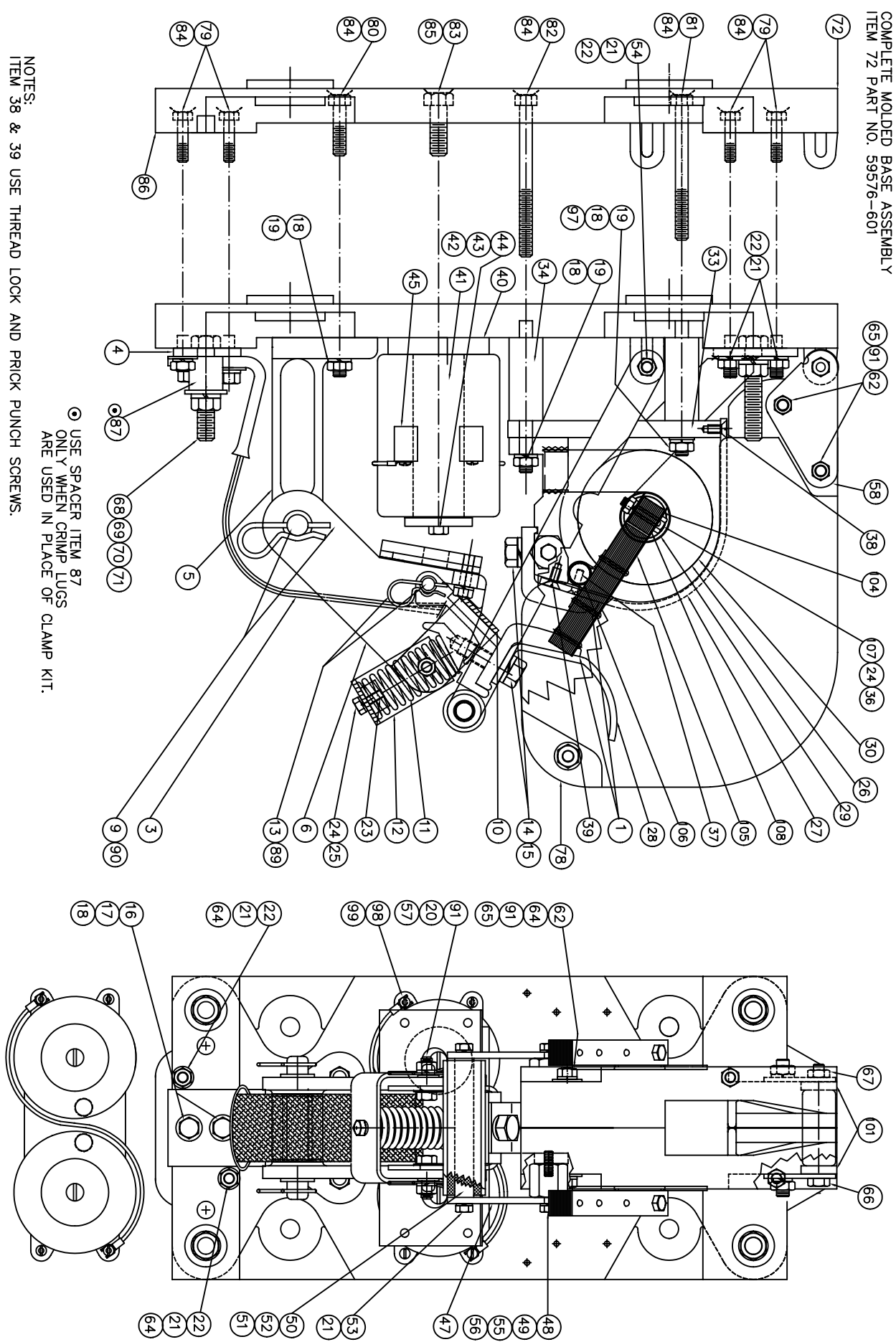

NOTES:
ITEM 38 & 39 USE THREAD LOCK AND PRICK PUNCH SCREWS.
○ USE SPACER ITEM 87 ONLY WHEN CRIMP LUGS ARE USED IN PLACE OF CLAMP KIT.

REV	DATE	BY	DESCRIPTION	LINE#	QTY	UNIT	NOTE	ANGLES	DRG. NO.	REF.
E	9-22-00	TJJ	ADDED ITEM 97	1	1	PUNCH	1.002	±.1	DRG. NO. 59576-601	REPAIR PARTS BULLETIN 5110
D	2-22-00	TJJ	UPDATED DRAWING	1	1	PUNCH	1.002	±.1	DRG. NO. 59576-601	MOLDED BASE FRONT REMOVABLE
C	2-22-00	TJJ	ADDED ITEMS 109 & 110	1	1	PUNCH	1.002	±.1	DRG. NO. 59576-601	600 AMP, 1 POLE, N.O.
B	11-21-97	TJJ	ADDED ITEMS 109 & 110	1	1	PUNCH	1.002	±.1	DRG. NO. 59576-601	AC CONTACTOR, SIZE 6
A	6-27-96	WSM	ARC TRANSFER WINGS CHANGED	1	1	PUNCH	1.002	±.1	DRG. NO. 59576-601	
Rev	DATE	BY	DESCRIPTION						DATE: 6-13-96	DR: WSM
										OK:
										REF:

21 20 19 18 17 16 15 14 13 12 11 10 9 8 7 6 5 4 3 2 1