

NOTE: THE FOLLOWING INFORMATION & SERIAL NUMBER FROM NAMEPLATE
 1. BULL. NUMBER
 2. PART NUMBER
 3. DESCRIPTION

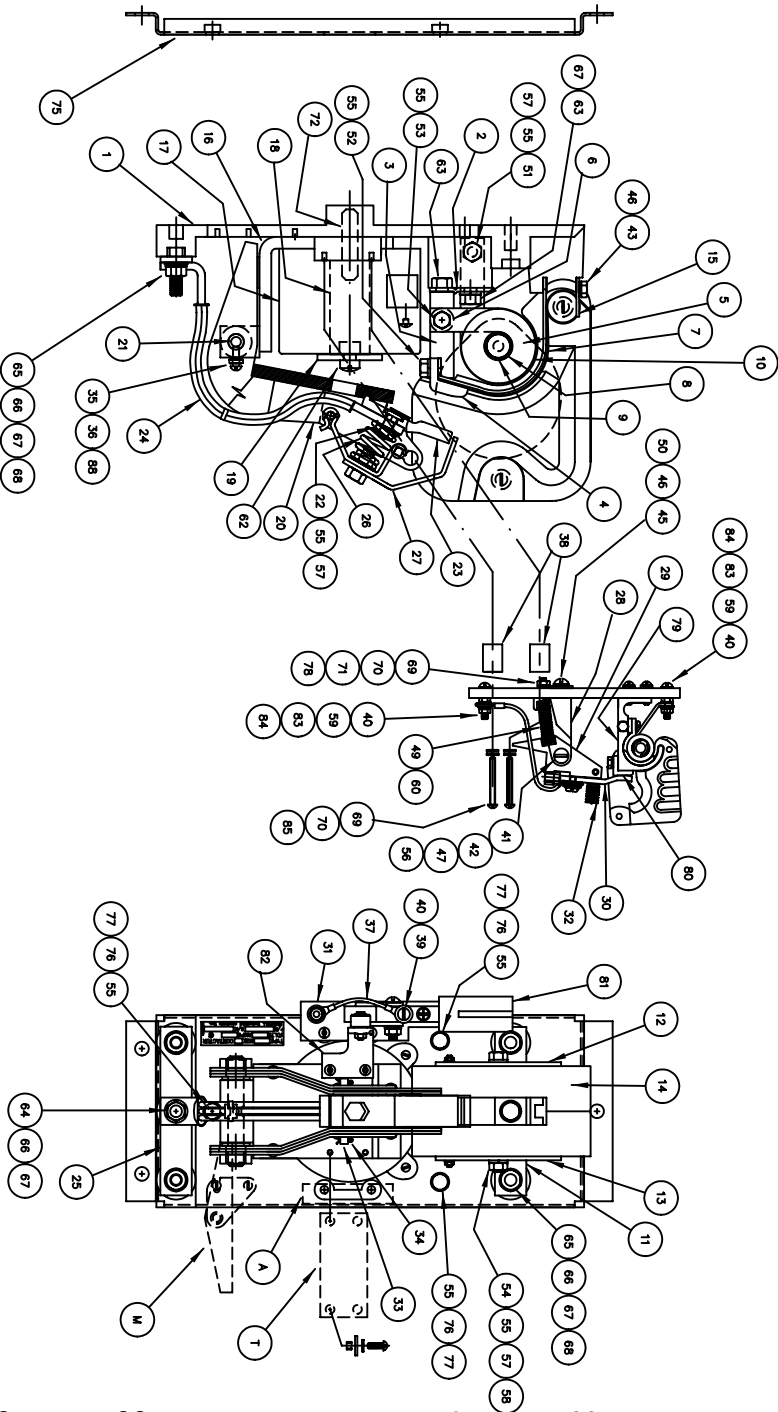

VOLTS	PART NUMBER	OHMS COLD
275	67890-001	1080
230/250	67890-002	900
115/125	67890-003	225
75	67890-004	82
57.5	67890-005	49
24	67890-006	8.6
36	67890-007	19
12	67890-008	2.22

ACCESSORIES

MUST BE ORDERED SEPARATELY - NOT FURNISHED WITH COMPLETE CONTACTOR

A	M	T
AUXILIARY CONTACTS	MECHANICAL INTERLOCK KIT	THE BAR KIT
SINGLE (1 N.O. & 1 N.C.) PART NO. 6801-008 DOUBLE (2 N.O. & 2 N.C.) PART NO. 6801-009	PART NO. 6804-004 FOR STANDARD 6.625" CONTACTOR SPACING (NOT MANUAL-MAGNETIC DISCONNECT)	PART NO. 59400-005 FOR STANDARD 6.625" CONTACTOR SPACING (NOT MANUAL-MAGNETIC DISCONNECT)
INCLUDES OPERATING STRIKER & MTG. HARDWARE REPAIR PARTS ON B-6801 PG. 1.	REPAIR PARTS ON A-59671	REPAIR PARTS ON A-59400 PG. 1

NOTES

- (1) COMPLETE CONTACTOR AVAILABLE WITHOUT MOUNTING PAN.
- (2) INCLUDES SUPPORT BOSS

ITEM	DESCRIPTION	NOTES	PART NO.	QTY.
1	BASE		68022-001	1
2	MOUNTING FOOT		68023-000	1
3	STATIONARY CONTACT BRACKET		58718-000	1
4	CONTACT TIP (COPPER)		18402-000	1
5	BLOWOUT COIL		18483-000	1
6	BLOWOUT COIL SPACER		18602-000	1
7	BLOWOUT GUARD		68030-000	1
8	D.C. BLOWOUT CORE (SOLID)		68870-033	1
9	BLOWOUT INSULATING TUBE		18601-000	1
10	UPPER TERMINAL ASSEMBLY		18603-000	2
11	FLUX PLATE ASSEMBLY - LEFT HAND	(2)	68028-000	1
12	FLUX PLATE ASSEMBLY - RIGHT HAND	(2)	18601-000	1
13	ARC SHIELD ASSEMBLY - LEFT HAND	(1)	18603-000	1
14	ARC SHIELD ASSEMBLY - RIGHT HAND	(1)	18603-000	1
15	ARC SHIELD RETAINER		59653-100	1
16	STATOR ASSEMBLY		18661-000	1
17	OPERATING COIL	SEE TABLE 1	58720-000	1
18	SOLE COIL		18675-000	1
19	CORE CAP		18123-000	1
20	ARMATURE ASSEMBLY		18049-000	1
21	ARMATURE BEARING PIN		18049-000	1
22	SHUNT HOLDING SCREW		41728-000	1
23	CONTACT FINGER (COPPER)		41719-000	1
24	FINGER SHUNT		68027-001	1
25	LOWER CONNECTING BUS		68024-001	1
26	CONTACT SPRING		41724-000	1
27	FINGER SPRING		68048-000	1
28	FINGER SHUNT RETAINER ASSEMBLY		41724-000	1
29	FINGER SHUNT SUPPORT		17713-000	1
30	FINGER SHUTTLE ASSEMBLY		17713-000	1
31	TUNG BASE (BLIMP OPEN CONTACTOR)		68043-001	1
32	FINGER SPRING		17716-000	1
33	FINGER RETAINER HINGE PIN		41733-000	1
34	COILTER PIN		51742-006	2
35	10-24 X 5/8 LG ROUND HEAD SCREW		41721-127	1
36	#10 SPRING LOCKWASHER		41723-036	1
37	FINGER SHUNT (25 AMP)		08298-000	1
38	PANEL SPACERS		68870-030	2
39	#10 FLATWASHER - BRASS		47800-128	1
40	#10 FLATWASHER - BRASS BR.		47251-008	5
41	1/4-20 X 1.0 LG R.H.M.S. STEEL		47241-185	1
42	SEAMLESS STEEL TUBE		17719-000	1
43	1/4-20 X 1 1/2 HEX HEAD SCREW		47246-089	1
44			47241-194	1
45	1/4-20 X .875 LG R.H.M.S. STEEL		47242-038	2
46	1/4-20 HEX NUT - BRASS		47254-012	1
47			70951-001	1
48	SPRING BUMPER (N/ATRON)		47248-041	1
49	1/2 FLATWASHER - BRASS		47246-079	1
50	5/16-18 X 3/4 HEX HEAD SCREW		47779-081	1
51	5/16-18 X 1 STAINLESS STEEL SCREW		47779-081	1
52	5/16-18 X 1-1/2 STAINLESS STEEL SCREW		47246-100	1
53	5/16-18 X 1-1/2 STAINLESS STEEL SCREW		47246-100	1
54	5/16-18 X 1 1/2 HEX HEAD SCREW		47246-100	1
55	5/16 SPRING LOCKWASHER		47252-039	1
56	1/4 INTERNAL LOCKWASHER		47304-009	1
57	5/16-18 NUT		47253-602	3
58	5/16 INTERNAL STAR LOCKWASHER		47304-010	1
59	#10-32 X 1.0 LG R.H.M.S. STEEL		47241-155	2
60	COMPRESSION SPRING		17711-000	1
61			48242-334	1
62	3/8-16 X 3/4 SLOTTED ELASTIC HEAD CAP SCR		48242-102	1
63	3/8-16 X 1/2 HEX HEAD SCREW		47246-102	3
64	3/8-16 X 1/2 HEX HEAD SCREW		47246-104	4
65	3/8-16 X 1 1/4 HEX HEAD SCREW		47250-020	6
66	3/8 WASHER		47250-020	4
67	3/8 SPRING LOCKWASHER		47253-603	4
68	3/8-16 NUT		47253-605	4
69	#8 FLATWASHER - BRASS		47251-007	3
70	#8 LOCKWASHER		47253-064	4
71	#8-32 HEX NUT STEEL		47253-014	1
72	STUD 1/2 - 13 X 1 15/16		66475-021	1
73				
74	PAN ASSEMBLY	(1)	68038-000	1
75	5/16-18 X 1 HER HEAD SCREW		47246-081	1
76	5/16-18 STEEL FLAT WASHER		47250-287	3
77	#8-32 X .750 LG R.H.M.S. STEEL		47241-105	1
78				

ITEM	DESCRIPTION	PART NO.	QTY.
79	25 AMP CONTACT ASSEMBLY (25A B.O.)	67246-014	1
80	CONTACT TIP (STATIONARY)	02315-000	1
81	ARC SHIELD ASSEMBLY	42355-001	1
82	KNOCKER ASSEMBLY	70953-004	1
83	#10-32 HEX NUT - STEEL	47253-017	4
84	#10 INTERNAL LOCKWASHER	47304-007	2
85	#8-32 X 1-1/2 LG R.H.M.S. STEEL	47241-110	2
86			
87	#10-24 HEX NUT	47253-016	1
88			

LINEAR	FINISH	HOLE	ANGLES	REPAIR PARTS BULL. 5210
0.X ±.000	FURNISH TO DIMEN.	0.X ±.002	45°	NEMA SIZE 5 300 AMP CONTACTOR WITH 25 AMP BLIMP OPEN
0.X ±.005	±.001	0.X ±.005	UNFIN.	MODULO BASE & WELDED ARMATURE
0.X ±.005	±.001	0.X ±.005	UNFIN.	
DATE 4-28-80	DR. WSM	CK.	REF.	
50 Edwards Street, Madison, WI 53705				