

COMPLETE MOLDED BASE ASSEMBLY  
ITEM 72 PART NO. 59576-601

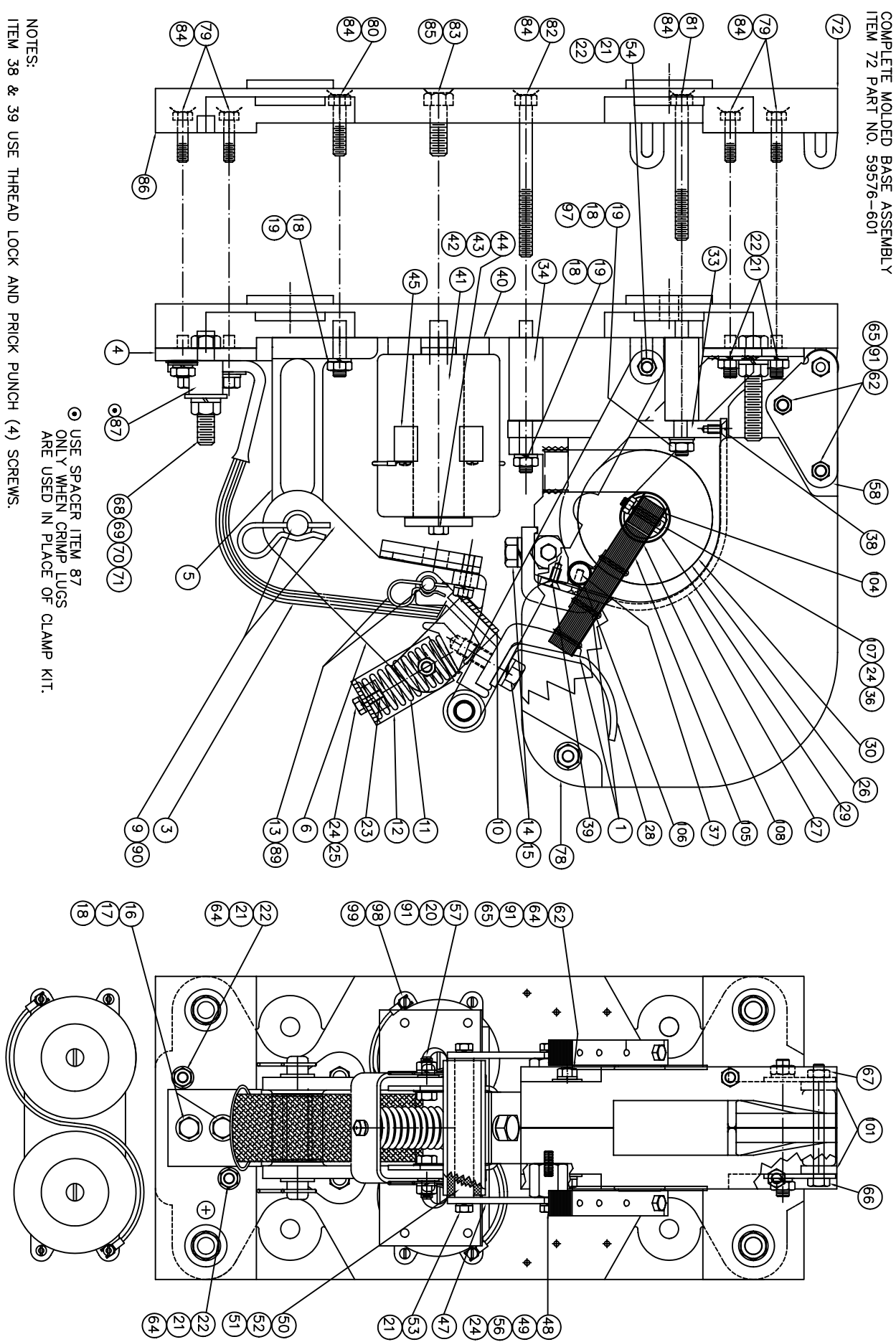

NOTES:  
ITEM 38 & 39 USE THREAD LOCK AND PRICK PUNCH (4) SCREWS.  
○ USE SPACER ITEM 87 ONLY WHEN CRIMP LUGS ARE USED IN PLACE OF CLAMP KIT.

Rev	DATE	BY	DESCRIPTION
A	6-27-96	WSM	ARC TRANSFER WINGS CHANGED
B	11-21-97	TJJ	ADDED ITEMS 109 & 110
C	2-22-00	TJJ	UPDATED DRAWING
D	9-22-00	TJJ	ADDED ITEM 97
E			

LINE#	QTY	PART NO.	DESCRIPTION	UNIT
1	1	59576-601	COMPLETE MOLDED BASE ASSEMBLY	EA
2	1	59576-601	COMPLETE MOLDED BASE ASSEMBLY	EA
3	1	59576-601	COMPLETE MOLDED BASE ASSEMBLY	EA
4	1	59576-601	COMPLETE MOLDED BASE ASSEMBLY	EA
5	1	59576-601	COMPLETE MOLDED BASE ASSEMBLY	EA
6	1	59576-601	COMPLETE MOLDED BASE ASSEMBLY	EA
7	1	59576-601	COMPLETE MOLDED BASE ASSEMBLY	EA
8	1	59576-601	COMPLETE MOLDED BASE ASSEMBLY	EA
9	1	59576-601	COMPLETE MOLDED BASE ASSEMBLY	EA
10	1	59576-601	COMPLETE MOLDED BASE ASSEMBLY	EA
11	1	59576-601	COMPLETE MOLDED BASE ASSEMBLY	EA
12	1	59576-601	COMPLETE MOLDED BASE ASSEMBLY	EA
13	1	59576-601	COMPLETE MOLDED BASE ASSEMBLY	EA
14	1	59576-601	COMPLETE MOLDED BASE ASSEMBLY	EA
15	1	59576-601	COMPLETE MOLDED BASE ASSEMBLY	EA
16	1	59576-601	COMPLETE MOLDED BASE ASSEMBLY	EA
17	1	59576-601	COMPLETE MOLDED BASE ASSEMBLY	EA
18	1	59576-601	COMPLETE MOLDED BASE ASSEMBLY	EA
19	1	59576-601	COMPLETE MOLDED BASE ASSEMBLY	EA
20	1	59576-601	COMPLETE MOLDED BASE ASSEMBLY	EA
21	1	59576-601	COMPLETE MOLDED BASE ASSEMBLY	EA

REPAIR PARTS BULLETIN 5110  
MOLDED BASE FRONT REMOVABLE  
1350 AMP, 1 POLE, N.O.  
AC CONTACTOR, SIZE 8

DATE: 06/13/96  
DR: WSM  
1 OF 2  
REF: DRG. NO. RPC-59800-4